



7.11-7.51

- Handle
- Hinge
- Lock
- Magnet Catch
- Door Lock
- Sliding Door Profile

Modular Assembly System

MAS

Machine Guard System

MGS

Stair and Platform System

SPS

Tubular Framing System

TFS

7

Door and Window Elements



P. 7-02



P. 7-03



P. 7-04



P. 7-05



P. 7-06

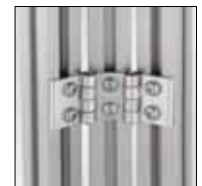

P. 7-09



P. 7-10

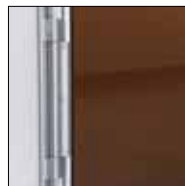

P. 7-11



P. 7-12



P. 7-14



P. 7-16



P. 7-17



Door and Window Elements

Handle

Material and Color: PA6, black

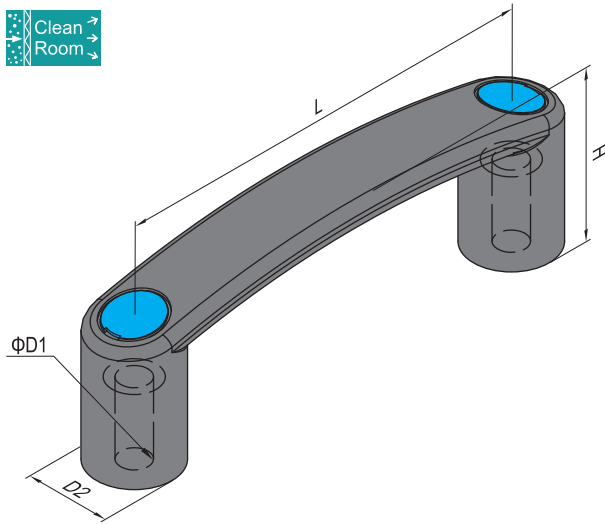
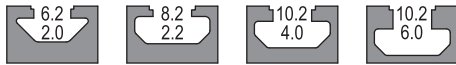
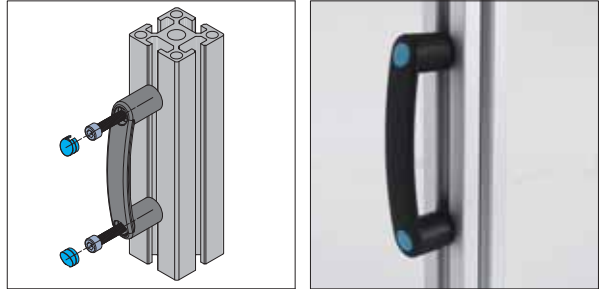

CA	Fastening Set	CB	Fastening Set	CD	Fastening Set	CE	Fastening Set
	M5x25 Bolt zinc plated		M6x25 Bolt zinc plated		M8x25 Bolt zinc plated		M8x30 Bolt zinc plated
	M5 T Nut nickel plated		M6 T Nut nickel plated		M8 T Nut nickel plated		M8 T Nut nickel plated

Description	PG	L (mm)	H (mm)	D1 (mm)	D2 (mm)	Fastening Set	Cap Color	Mass (g)	Part No.
PA6 Handle-90 (pc)	PG15/20	90	36	6.5	18			23	7.11.90.06.BE
PA6 Handle-90 (set)						2xCA		41	7.11.90.06.BE.ST
PA6 Handle-90 (pc)								23	7.11.90.06.BK
PA6 Handle-90 (set)						2xCA		41	7.11.90.06.BK.ST
PA6 Handle-90 (pc)	PG30	90	36	6.5	18			23	7.11.90.08.BE
PA6 Handle-90 (set)						2xCB		45	7.11.90.08.BE.ST
PA6 Handle-90 (pc)								23	7.11.90.08.BK
PA6 Handle-90 (set)						2xCB		45	7.11.90.08.BK.ST
PA6 Handle-120 (pc)	PG30	120	40	8.5	25			45	7.11.120.08.BE
PA6 Handle-120 (set)						2xCB		68	7.11.120.08.BE.ST
PA6 Handle-120 (pc)								45	7.11.120.08.BK
PA6 Handle-120 (set)						2xCB		68	7.11.120.08.BK.ST
PA6 Handle-120 (pc)	PG40	120	40	8.5	25			45	7.11.120.10.04.BE
PA6 Handle-120 (set)						2xCD		88	7.11.120.10.04.BE.ST
PA6 Handle-120 (pc)								45	7.11.120.10.04.BK
PA6 Handle-120 (set)						2xCD		88	7.11.120.10.04.BK.ST
PA6 Handle-120 (pc)	PG45/50/60	120	40	8.5	25			45	7.11.120.10.06.BE
PA6 Handle-120 (set)						2xCE		104	7.11.120.10.06.BE.ST
PA6 Handle-120 (pc)								45	7.11.120.10.06.BK
PA6 Handle-120 (set)						2xCE		104	7.11.120.10.06.BK.ST



Door and Window Elements

Guard Wing Handle

Material and Color: PA6, black

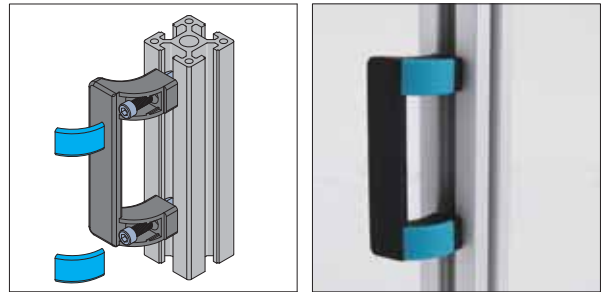
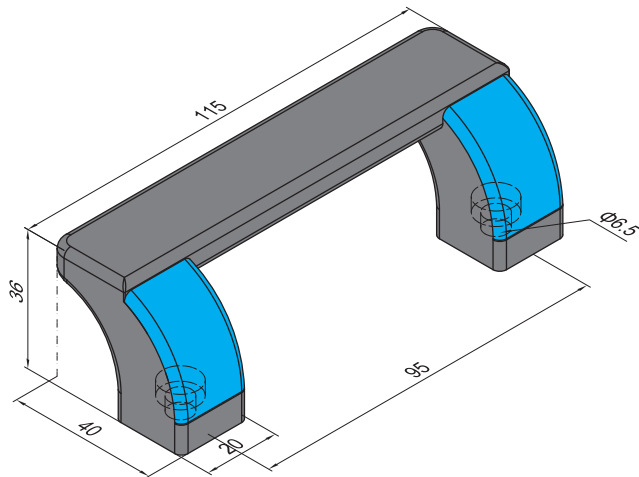
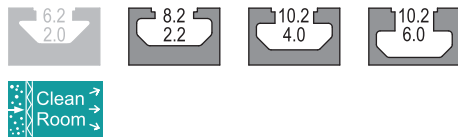

CP	Fastening Set	CQ	Fastening Set
	M6x12 Bolt zinc plated		M6x16 Bolt zinc plated
	M6 T Nut nickel plated		M6 T Nut nickel plated

Description	PG	Fastening Set	Cap Color	Mass (g)	Part No.
Guard Wing Handle -95 (pc)	PG30			70	7.12.95.08.BE
Guard Wing Handle -95 (set)		2xCQ		88	7.12.95.08.BE.ST
Guard Wing Handle -95 (pc)				70	7.12.95.08.BK
Guard Wing Handle -95 (set)		2xCQ		88	7.12.95.08.BK.ST
Guard Wing Handle -95 (pc)	PG40/45/50/60			70	7.12.95.10.BE
Guard Wing Handle -95 (set)		2xCQ		96	7.12.95.10.BE.ST
Guard Wing Handle -95 (pc)				70	7.12.95.10.BK
Guard Wing Handle -95 (set)		2xCQ		96	7.12.95.10.BK.ST

Modular Assembly System

MAS

Machine Guard System

MGS

Stair and Platform System

SPS

Tubular Framing System

TFS



Door and Window Elements

Aluminum Handle



Material: handle-aluminum Cap-ABS Cap Color: gray and black

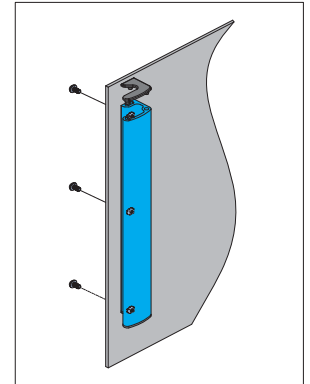
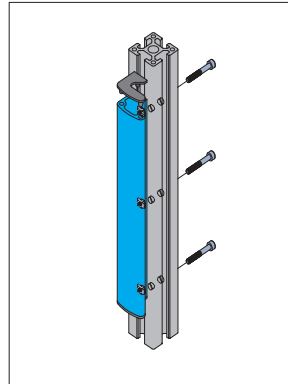
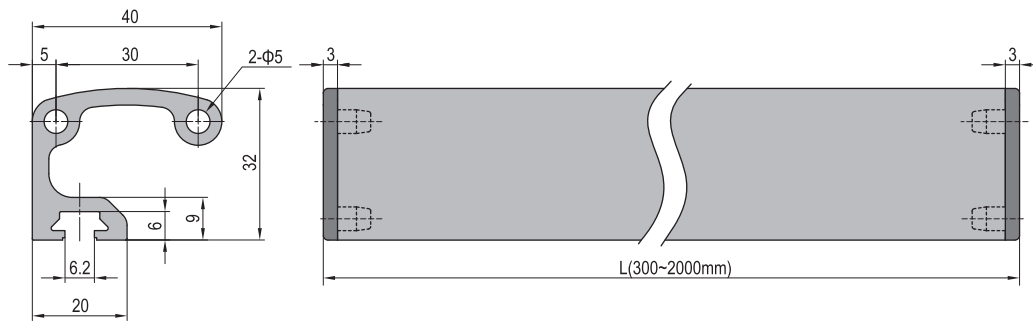
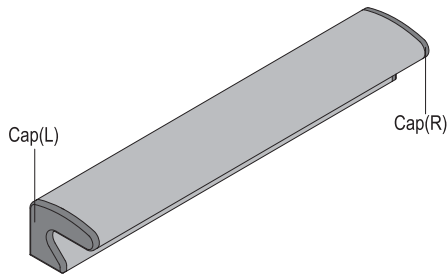

PA	Fastening Set	PB	Fastening Set
	M5x10 Bolt zinc plated		M5x35 Bolt zinc plated
	M5 Washer zinc plated		M5 T Nut nickel plated
	M5 T Nut nickel plated		

Application	Description	Cap Color	L (mm)	Fastening Set	Mass (g)	Part No.	
4mm Panel	Aluminum Handle (pc)		300		216	7.13.P.GY	
	Aluminum Handle (set)			3×PA	224	7.13.P.GY.ST	
	Aluminum Handle (pc)				216	7.13.P.BK	
	Aluminum Handle (set)			3×PA	224	7.13.P.BK.ST	
PG40/45	Aluminum Handle (pc)					216	7.13.10.GY
	Aluminum Handle (set)			3×PB	231	7.13.10.GY.ST	
	Aluminum Handle (pc)					216	7.13.10.BK
	Aluminum Handle (set)			3×PB	231	7.13.10.BK.ST	

Note:1. Single supply including 3 of M5 T Nuts (Reference No.2.21.06.M5).

2. The length could be customized according to customer's requirements(300~2000mm).

ex: 7.13.P.GY - 500



Door and Window Elements

Hinge

Material and Color: black PA6

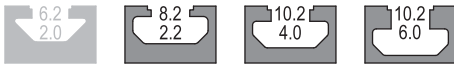

Hinge-PA6

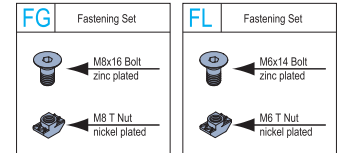
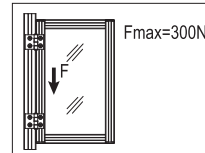
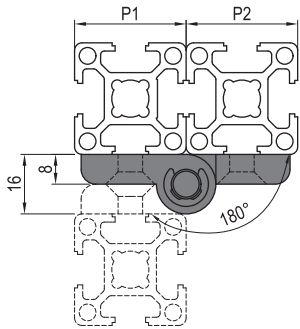
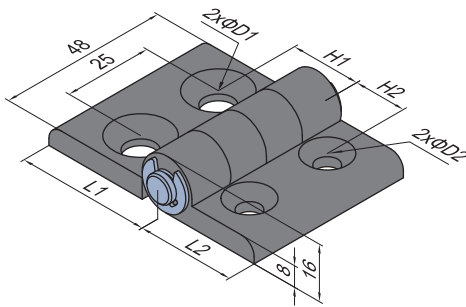

Description	H1 (mm)	H2 (mm)	L1 (mm)	L2 (mm)	D1 (mm)	D2 (mm)	Fastening Set	Mass (g)	Part No.
30/30 (pc)	15	15	28	28	6.5	6.5		39	7.21.30.30
30/30 (set)							4xFL	73	7.21.30.30.ST
30/40 (pc)	20	15	38	28	8.5	6.5		42	7.21.30.40
30/40 (set)							2xFG+2xFL	88	7.21.30.40.ST
30/45 (pc)	22.5	15	43	28	8.5	6.5		44	7.21.30.45 New!
30/45 (set)							2xFG+2xFL	81	7.21.30.45.ST New!
40/40 (pc)	20	20	38	38	8.5	8.5		45	7.21.40.40
40/40 (set)							4xFG	108	7.21.40.40.ST
40/45 (pc)	22.5	20	43	38	8.5	8.5		47	7.21.40.45 New!
40/45 (set)							4xFG	110	7.21.40.45.ST New!
45/45 (pc)	22.5	22.5	43	43	8.5	8.5		49	7.21.45.45 New!
45/45 (set)							4xFG	112	7.21.45.45.ST New!



Door and Window Elements

Hinge **New!** **Economical**

Material and Color: aluminum, nature anodized



Light Hinge-Aluminum Countersink Hole

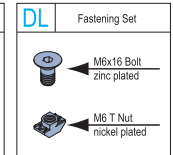
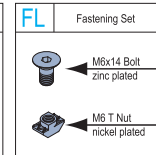
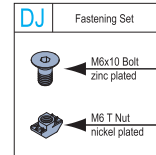
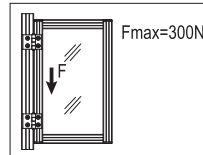
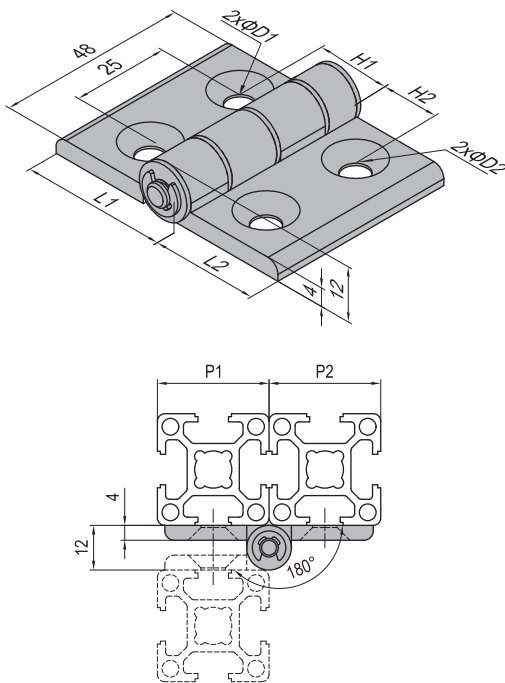

Description	H1 (mm)	H2 (mm)	L1 (mm)	L2 (mm)	D1 (mm)	D2 (mm)	Fastening Set	Mass (g)	Part No.
30/30 (pc)	15	15	28	28	6.5	6.5		41	7.22.30.30.E
30/30 (set)							4xDJ	65	7.22.30.30.E.ST
30/40 (pc)	20	15	38	28	6.5	6.5		46	7.22.30.40.E
30/40 (set)							2xDJ+2xFL	80	7.22.30.40.E.ST
30/45 (pc)	22.5	15	38	28	6.5	6.5		46	7.22.30.45.E
30/45 (set)							2xDJ+2xDL	80	7.22.30.45.E.ST
40/40 (pc)	20	20	38	38	6.5	6.5		51	7.22.40.40.E
40/40 (set)							4xFL	94	7.22.40.40.E.ST
40/45 (pc)	22.5	20	38	38	6.5	6.5		51	7.22.40.45.E
40/45 (set)/							2xFL+2xDL	95	7.22.40.45.E.ST
45/45 (pc)	22.5	22.5	38	38	6.5	6.5		51	7.22.45.45.E
45/45 (set)							4xDL	96	7.22.45.45.E.ST



Door and Window Elements

Hinge

Material and Color: aluminum, nature anodized



Hinge-Aluminum Countersink Hole

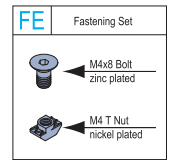
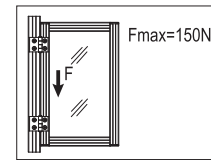
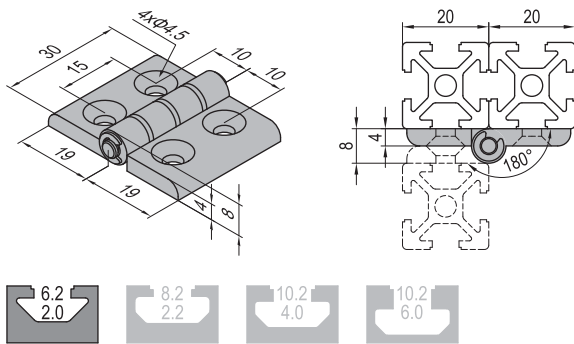

Description	Fastening Set	Mass (g)	Part No.
20/20 (pc)		15	7.22.20.20
20/20 (set)	4xFE	25	7.22.20.20.ST

Hinge-Aluminum Countersink Hole

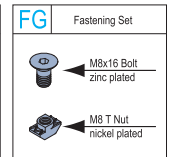
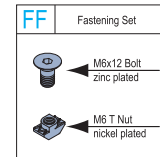
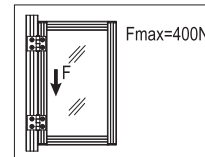
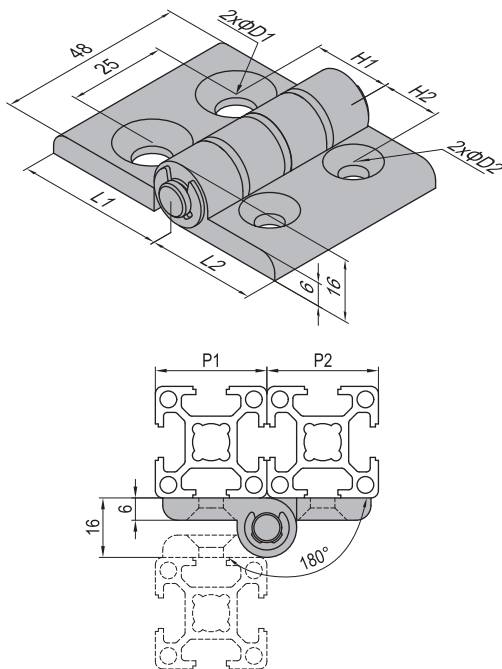

Description	H1 (mm)	H2 (mm)	L1 (mm)	L2 (mm)	D1 (mm)	D2 (mm)	Fastening Set	Mass (g)	Part No.
30/30 (pc)	15	15	28	28	6.5	6.5		69	7.22.30.30
30/30 (set)							4xFF	97	7.22.30.30.ST
30/40 (pc)	20	15	38	28	8.5	6.5		74	7.22.30.40
30/40 (set)							2xFF+2xFG	122	7.22.30.40.ST
30/45 (pc)	22.5	15	38	28	8.5	6.5		74	7.22.30.45
30/45 (set)							2xFF+2xFG	122	7.22.30.45.ST
40/40 (pc)	20	20	38	38	8.5	8.5		81	7.22.40.40
40/40 (set)							4xFG	149	7.22.40.40.ST
40/45 (pc)	22.5	20	38	38	8.5	8.5		81	7.22.40.45
40/45 (set)							4xFG	149	7.22.40.45.ST
45/45 (pc)	22.5	22.5	38	38	8.5	8.5		81	7.22.45.45
45/45 (set)							4xFG	149	7.22.45.45.ST



Door and Window Elements

Hinge

Material and Color: aluminum, nature anodized



Hinge-Aluminum Through Hole

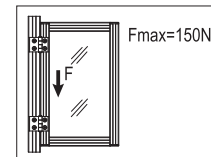
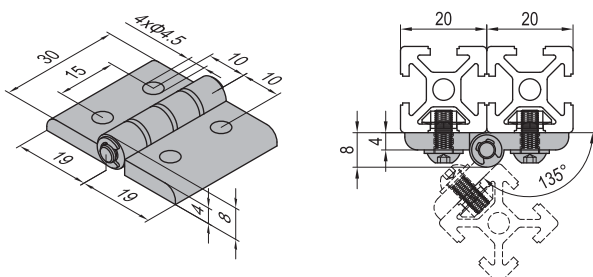

PC	Fastening Set
	M4x10 Bolt zinc plated
	M4 Washer zinc plated
	M4 T Nut nickel plated

Description	Fastening Set	Mass (g)	Part No.
20/20 (pc)		15	7.23.20.20
20/20 (set)	4xPC	29	7.23.20.20.ST

Hinge-Aluminum Through Hole

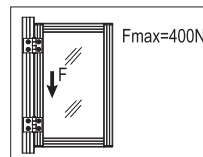
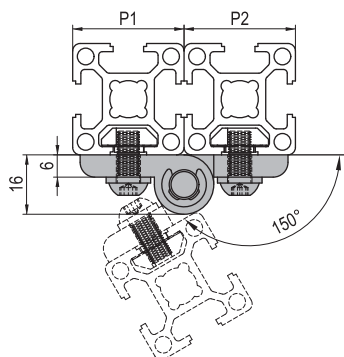
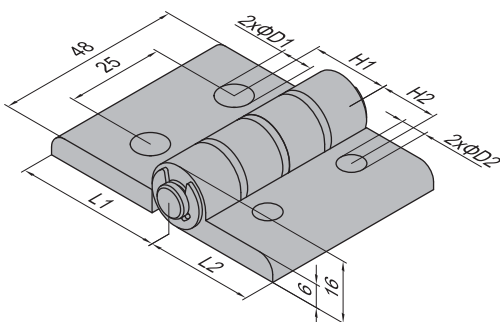

FH	Fastening Set
	M6x14 Bolt zinc plated
	M6 Washer zinc plated
	M6 T Nut nickel plated

FJ	Fastening Set
	M6x16 Bolt zinc plated
	M6 Washer zinc plated
	M6 T Nut nickel plated

FK	Fastening Set
	M8x20 Bolt zinc plated
	M8 Washer zinc plated
	M8 T Nut nickel plated

Description	H1 (mm)	H2 (mm)	L1 (mm)	L2 (mm)	D1 (mm)	D2 (mm)	Fastening Set	Mass (g)	Part No.
30/30 (pc)	15	15	28	28	6.5	6.5		71	7.23.30.30
30/30 (set)							4xFH	99	7.23.30.30.ST
30/40 (pc)	20	15	38	28	8.5	6.5		76	7.23.30.40
30/40 (set)							2xFH+2xFJ	124	7.23.30.40.ST
30/45 (pc)	22.5	15	38	28	8.5	6.5		76	7.23.30.45
30/45 (set)							2xFH+2xFK	127	7.23.30.45.ST
40/40 (pc)	20	20	38	38	8.5	8.5		83	7.23.40.40
40/40 (set)							4xFJ	151	7.23.40.40.ST
40/45 (pc)	22.5	20	38	38	8.5	8.5		83	7.23.40.45
40/45 (set)							2xFJ+2xFK	156	7.23.40.45.ST
45/45 (pc)	22.5	22.5	38	38	8.5	8.5		83	7.23.45.45
45/45 (set)							4xFK	161	7.23.45.45.ST



Door and Window Elements

Hinge

Material and Color: aluminum, nature anodized

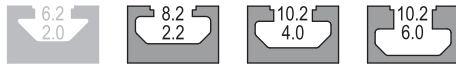

Hinge-Aluminum Countersink Hole

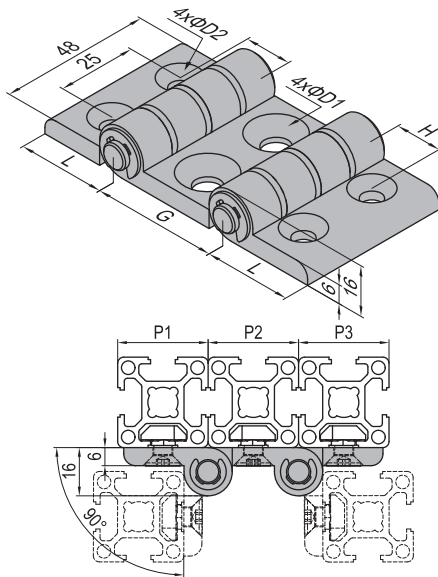

Hinge-Aluminum Through Hole

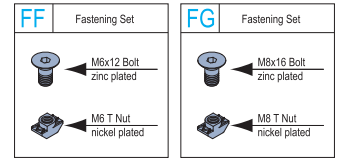
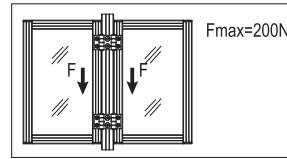
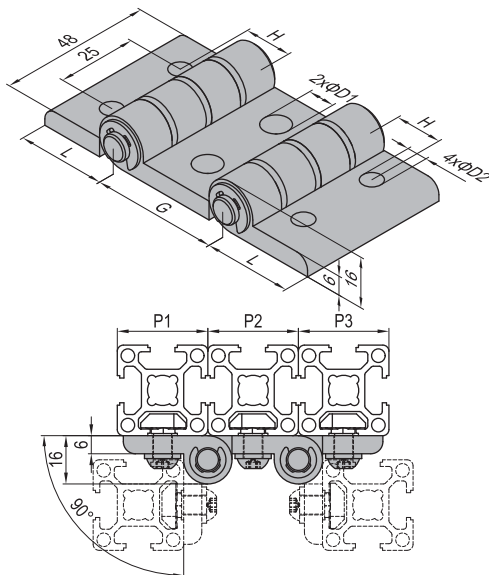

Description	G (mm)	H (mm)	L (mm)	D1 (mm)	D2 (mm)	Fastening Set	Mass (g)	Part No.
30/30/30 (pc)	30	15	28	6.5	6.5		98	7.24.30.30.30
30/30/30 (set)						6xFF	140	7.24.30.30.30.ST
30/40/30 (pc)	40	15	28	8.5	6.5		104	7.24.30.40.30
30/40/30 (set)						4xFF+2xFG	166	7.24.30.40.30.ST
30/45/30 (pc)	45	15	28	8.5	6.5		108	7.24.30.45.30
30/45/30 (set)						4xFF+2xFG	170	7.24.30.45.30.ST
40/40/40 (pc)	40	20	38	8.5	8.5		115	7.24.40.40.40
40/40/40 (set)						6xFG	217	7.24.40.40.40.ST
40/45/40 (pc)	45	20	38	8.5	8.5		119	7.24.40.45.40
40/45/40 (set)						6xFG	221	7.24.40.45.40.ST
45/45/45 (pc)	45	22.5	38	8.5	8.5		119	7.24.45.45.45
45/45/45 (set)						6xFG	221	7.24.45.45.45.ST

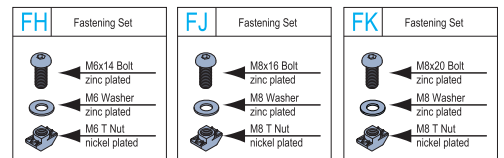
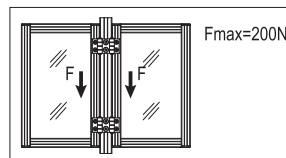

Description	G (mm)	H (mm)	L (mm)	D1 (mm)	D2 (mm)	Fastening Set	Mass (g)	Part No.
30/30/30 (pc)	30	15	28	6.5	6.5		100	7.25.30.30.30
30/30/30 (set)						6xFH	142	7.25.30.30.30.ST
30/40/30 (pc)	40	15	28	8.5	6.5		107	7.25.30.40.30
30/40/30 (set)						4xFH+2xFJ	169	7.25.30.40.30.ST
30/45/30 (pc)	45	15	28	8.5	6.5		111	7.25.30.45.30
30/45/30 (set)						4xFH+2xFK	175	7.25.30.45.30.ST
40/40/40 (pc)	40	20	38	8.5	8.5		121	7.25.40.40.40
40/40/40 (set)						6xFJ	213	7.25.40.40.40.ST
40/45/40 (pc)	45	20	38	8.5	8.5		125	7.25.40.45.40
40/45/40 (set)						4xFJ+2xFK	230	7.25.40.45.40.ST
45/45/45 (pc)	45	22.5	38	8.5	8.5		125	7.25.45.45.45
45/45/45 (set)						6xFK	245	7.25.45.45.45.ST



Door and Window Elements

Hinge

Material and Color: aluminum, nature anodized

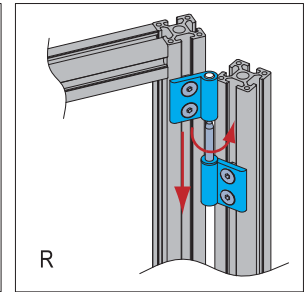
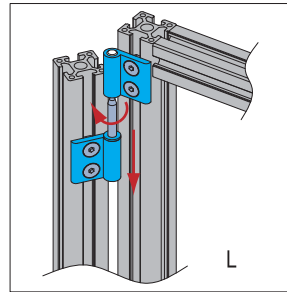

Hinge-AL Removable Hinge-L

Hinge-AL Removable Hinge-R

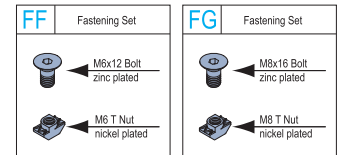
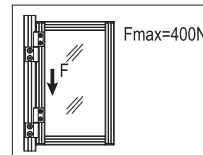
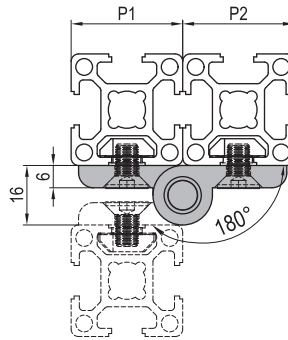
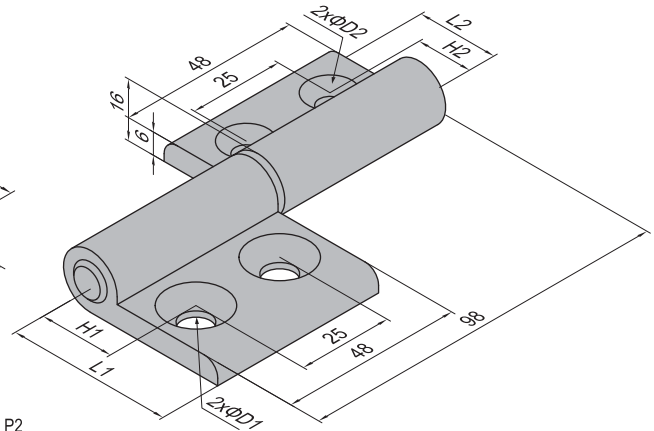
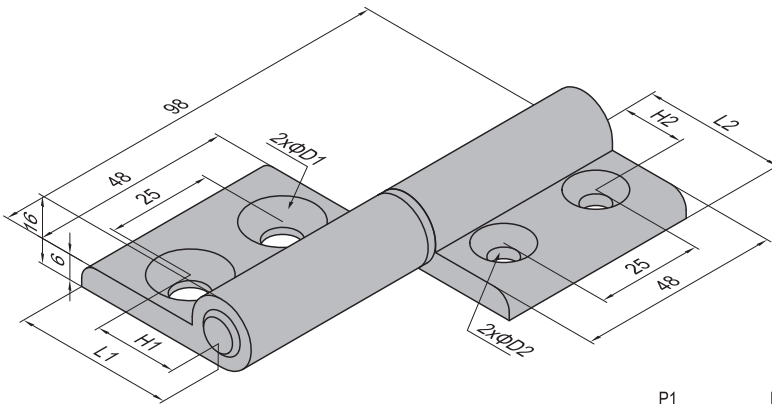

Description	H1 (mm)	H2 (mm)	L1 (mm)	L2 (mm)	D1 (mm)	D2 (mm)	Fastening Set	Mass (g)	Part No.(L)	Part No.(R)
30/30 (pc)	15	15	28	28	6.5	6.5		105	7.26.30.30	7.27.30.30
30/30 (set)							4xFF	133	7.26.30.30.ST	7.27.30.30.ST
30/40 (pc)	20	15	38	28	8.5	6.5		110	7.26.30.40	7.27.30.40
30/40 (set)							2xFF+2xFG	158	7.26.30.40.ST	7.27.30.40.ST
30/45 (pc)	22.5	15	38	28	8.5	6.5		110	7.26.30.45	7.27.30.45
30/45 (set)							2xFF+2xFG	158	7.26.30.45.ST	7.27.30.45.ST
40/40 (pc)	20	20	38	38	8.5	8.5		118	7.26.40.40	7.27.40.40
40/40 (set)							4xFG	186	7.26.40.40.ST	7.27.40.40.ST
40/45 (pc)	22.5	20	38	38	8.5	8.5		118	7.26.40.45	7.27.40.45
40/45 (set)							4xFG	186	7.26.40.45.ST	7.27.40.45.ST
45/45 (pc)	22.5	22.5	38	38	8.5	8.5		118	7.26.45.45	7.27.45.45
45/45 (set)							4xFG	186	7.26.45.45.ST	7.27.45.45.ST

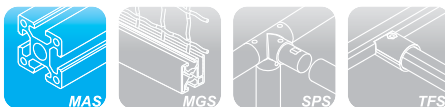

Door and Window Elements

Hinge

Material and Color: aluminum, nature anodized



Hinge-Long Aluminum Hinge

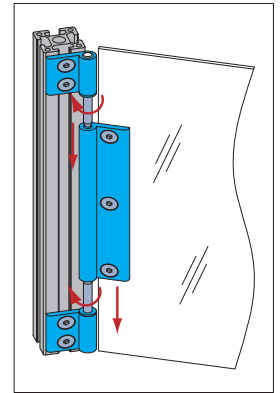
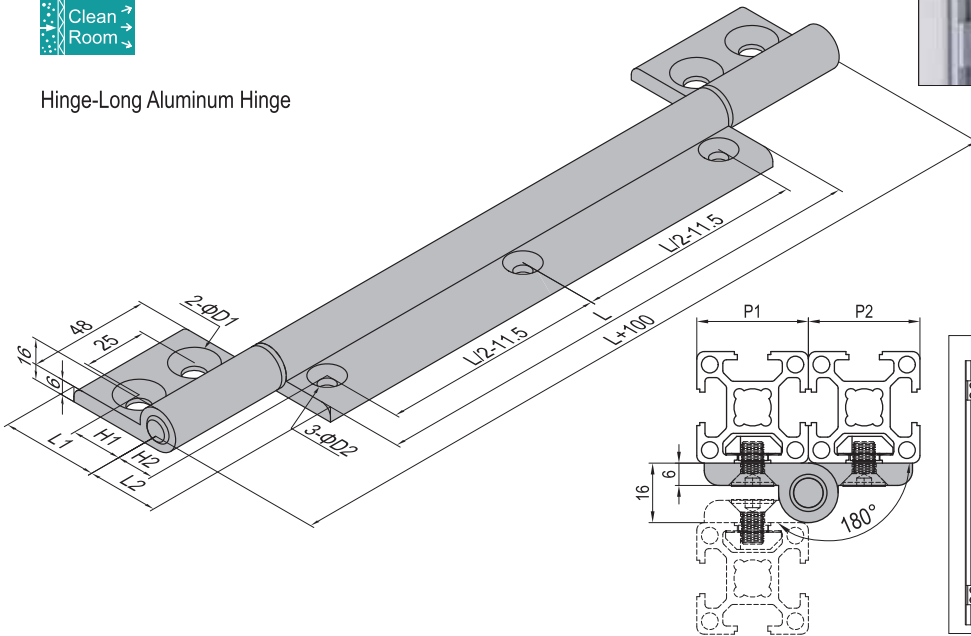

FF	Fastening Set	FG	Fastening Set
	M8x12 Bolt zinc plated		M8x16 Bolt zinc plated
	M8 T Nut nickel plated		M8 T Nut nickel plated

Description	H1 (mm)	H2 (mm)	L1 (mm)	L2 (mm)	D1 (mm)	D2 (mm)	L (mm)	Fastening Set	Mass (g)	Part No.
30/30 (pc)	15	15	28	28	6.5	6.5	500		502	7.28.30.30
30/30 (set)								7×FF	558	7.28.30.30.ST
30/40 (pc)	20	15	38	28	8.5	6.5			512	7.28.30.40
30/40 (set)								3×FF+4×FG	604	7.28.30.40.ST
30/45 (pc)	22.5	15	38	28	8.5	6.5			512	7.28.30.45
30/45 (set)								3×FF+4×FG	604	7.28.30.45.ST
40/40 (pc)	20	20	38	38	8.5	8.5			587	7.28.40.40
40/40 (set)								7×FG	706	7.28.40.40.ST
40/45 (pc)	22.5	20	38	38	8.5	8.5			587	7.28.40.45
40/45 (set)								7×FG	706	7.28.40.45.ST
45/45 (pc)	22.5	22.5	38	38	8.5	8.5			587	7.28.45.45
45/45 (set)								7×FG	706	7.28.45.45.ST

Note: The length could be customized according to customer's requirements(100~1000mm).

ex: 7.28.30.30 - 1000

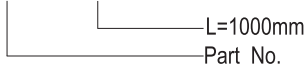

Modular Assembly System
MAS
Machine Guard System
MGS
Stair and Platform System
SPS
Tubular Framing System
TFS



Door and Window Elements



Lock

Compact metal lock with self-locking design.

Material and Color: diecast zinc, black electrophoresis

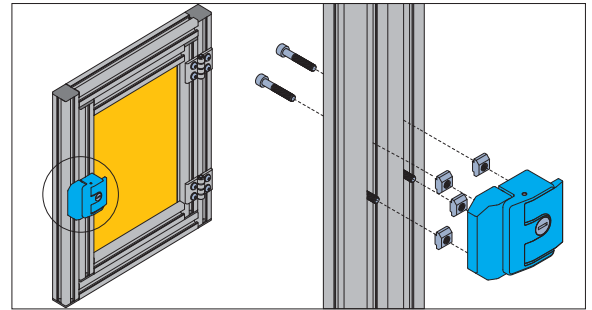
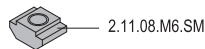
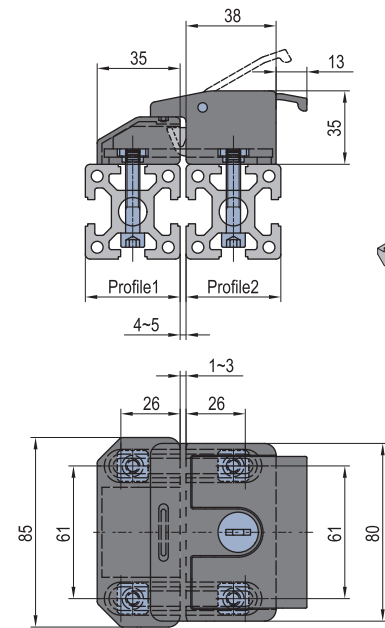

EL	Fastening Set	EM	Fastening Set	EN	Fastening Set
	M6x30 Bolt zinc plated		M6x40 Bolt zinc plated		M6x45 Bolt zinc plated

Description	Profile 1	Profile 2	Fastening Set	Mass (g)	Part No.
Lock (pcs)				690	7.31
Lock-3030 (set)	PG30	PG30	4xEL	719	7.31.30.30
Lock-4030 (set)	PG40	PG30	2xEL 2xEM	724	7.31.40.30
Lock-4040 (set)	PG40	PG40	4xEM	728	7.31.40.40
Lock-4530 (set)	PG45	PG30	2xEL 2xEN	726	7.31.45.30
Lock-4540 (set)	PG45	PG40	2xEM 2xEN	731	7.31.45.40
Lock-4545 (set)	PG45	PG45	4xEN	733	7.31.45.45

Note: Including special nuts.



Door and Window Elements



Lock

Material and Color: zinc alloy, polish finish



L Lock

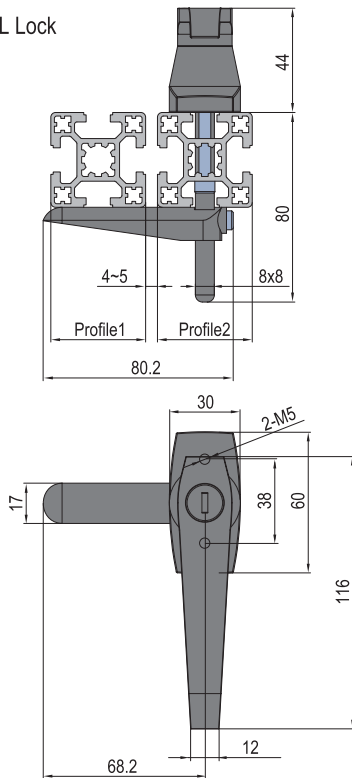

T Lock

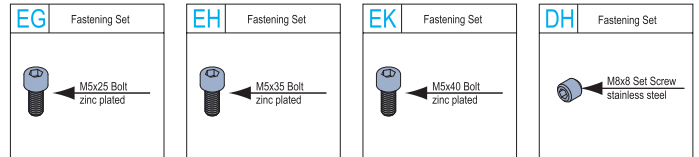
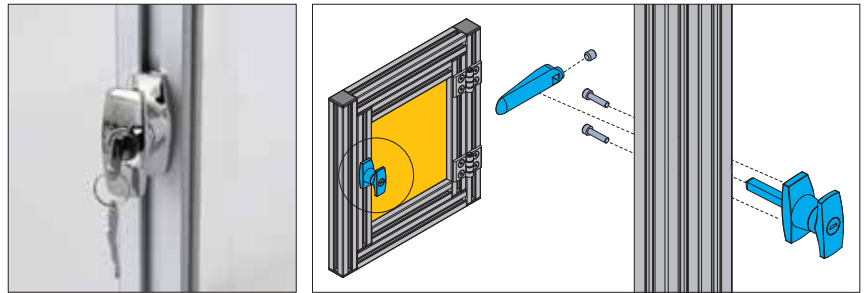
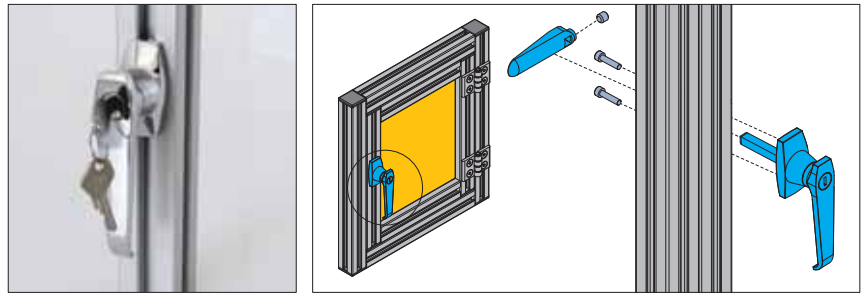
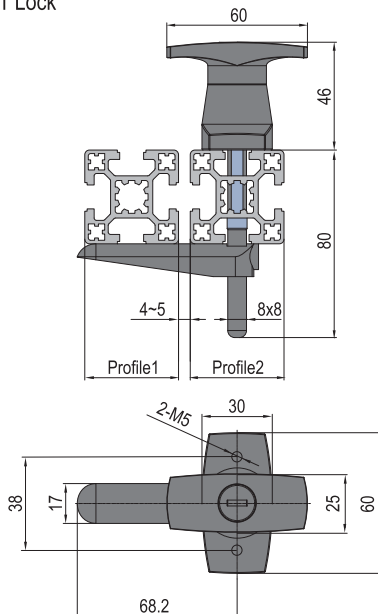

Description	Profile 1	Profile 2	Fastening Set	Mass (g)	Part No.
L Lock-3030	PG30	PG30			7.32.30.30
L Lock-4030	PG40	PG30	DH+2xEG	290	7.32.40.30
L Lock-4530	PG45	PG30			7.32.45.30
L Lock-4040	PG40	PG40			7.32.40.40
L Lock-4540	PG45	PG40	DH+2xEH	294	7.32.45.40
L Lock-4545	PG45	PG45	DH+2xEK	296	7.32.45.45
T Lock-3030	PG30	PG30			7.33.30.30
T Lock-4030	PG40	PG30	DH+2xEG	270	7.33.40.30
T Lock-4530	PG45	PG30			7.33.45.30
T Lock-4040	PG40	PG40			7.33.40.40
T Lock-4540	PG45	PG40	DH+2xEH	274	7.33.45.40
T Lock-4545	PG45	PG45	DH+2xEK	276	7.33.45.45

Modular Assembly System

MAS

Machine Guard System

MGS

Stair and Platform System

SPS

Tubular Framing System

TFS











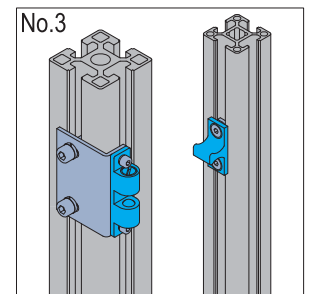
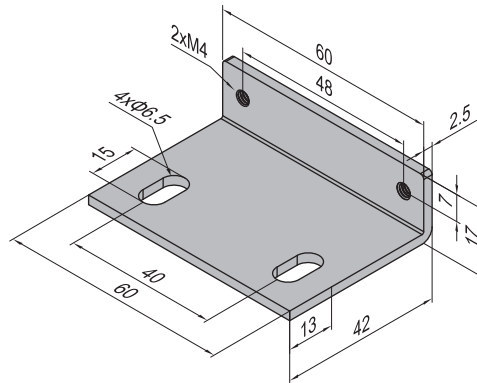
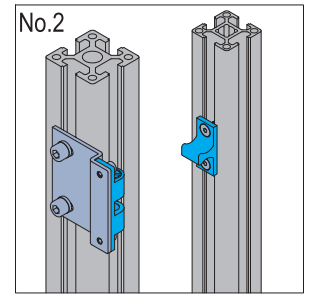
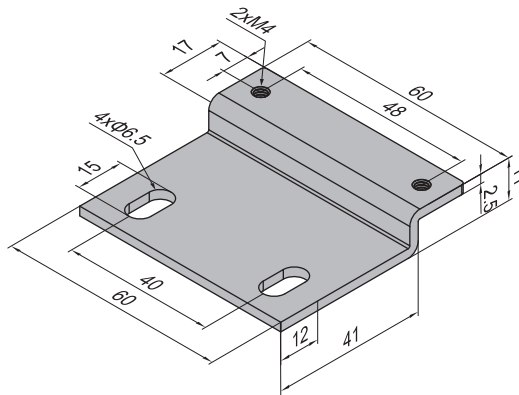
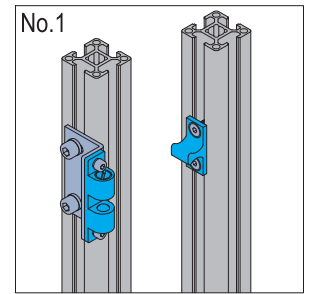
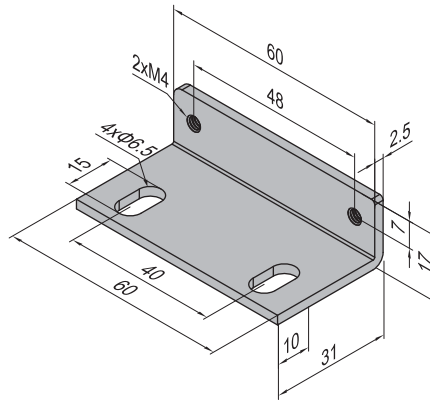
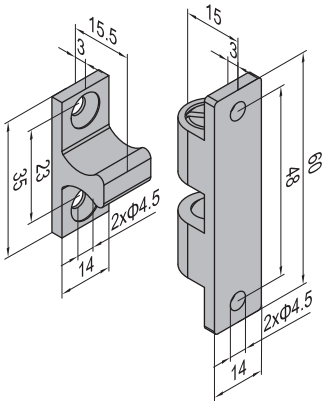





Door and Window Elements

Magnet Catch

Material: Magnet Catch-aluminum alloy, hard oxidation anodized
Connectors-zinc plated steel

Note: When the magnet catch is installed on the lower door frame, the door should be more than 400mm.



CF Fastening Set	PF Fastening Set	CJ Fastening Set	CK Fastening Set	CN Fastening Set
 M4x10 Bolt zinc plated  M4 T Nut nickel plated	 M4x8 Bolt zinc plated  M4 Spring Washer zinc plated  M4 Washer zinc plated	 M6x10 Bolt zinc plated  M6 Spring Washer zinc plated  M6 T Nut nickel plated	 M6x14 Bolt zinc plated  M6 Spring Washer zinc plated  M6 T Nut nickel plated	 M6x16 Bolt zinc plated  M6 Spring Washer zinc plated  M6 T Nut nickel plated

Description	Fastening Set	Mass (g)	Part No.
Magnet Catch-14 (pcs)		26	7.41.14
Magnet Catch-14 (Profile 3030 for Door' Profile 3030 for Doorframe set No.1)	2xCF+2xPF+2xCJ	130	7.41.14.3030.ST
Magnet Catch-14 (Profile 3030 for Door' Profile 4040 for Doorframe set No.2)	2xCF+2xPF+2xCK	139	7.41.14.3040.ST
Magnet Catch-14 (Profile 3030 for Door, Profile 4545 for Doorframe set No.3)	2xCF+2xPF+2xCN	145	7.41.14.3045.ST



Door and Window Elements

Magnet Catch

Material: Magnet Catch-aluminum alloy, hard oxidation anodized
Connector-zinc plated steel
(Material for Connector 4080 is aluminum alloy)

Note: When the magnet catch is installed on the lower door frame, the door should be more than 400mm.

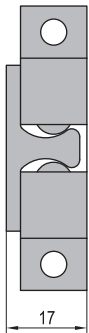

Tighten Status 1

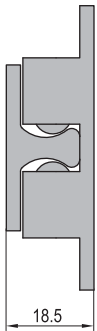

Tighten Status 2

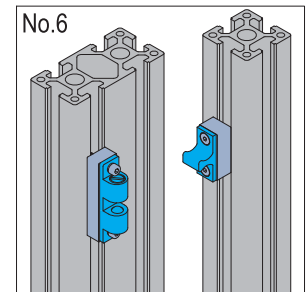
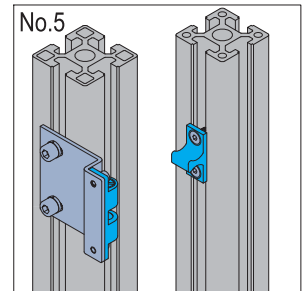
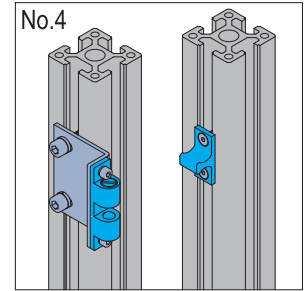
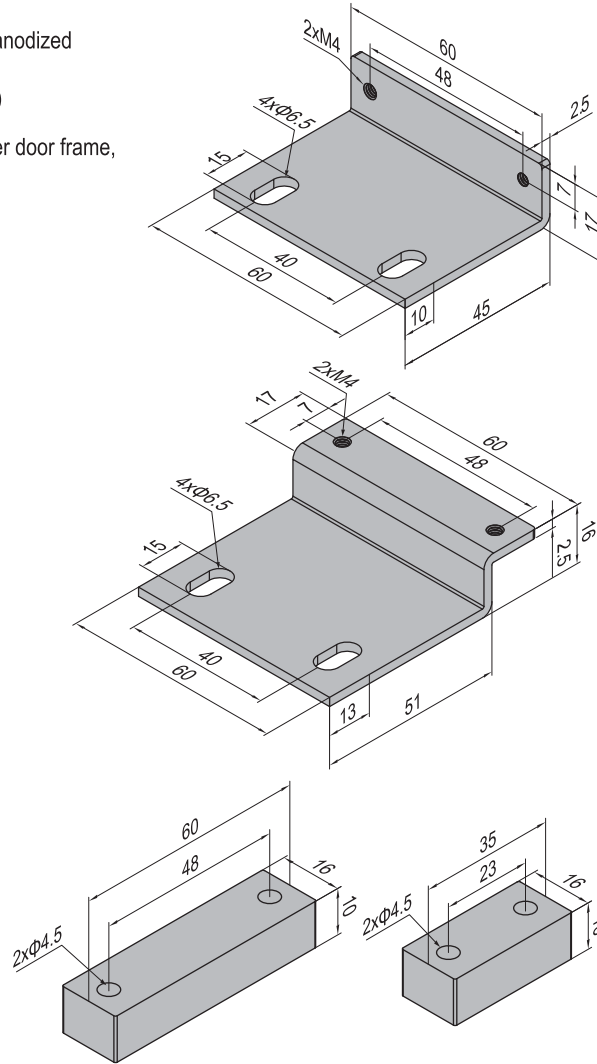

CG Fastening Set M4x14 Bolt zinc plated M4 T Nut nickel plated	PF Fastening Set M4x8 Bolt zinc plated M4 Spring Washer zinc plated M4 Washer zinc plated	CK Fastening Set M6x14 Bolt zinc plated M6 Spring Washer zinc plated M6 T Nut nickel plated	CL Fastening Set M4x25 Bolt zinc plated M4 Spring Washer zinc plated M4 T Nut nickel plated	CY Fastening Set M4x20 Bolt zinc plated M4 T Nut nickel plated	CN Fastening Set M6x16 Bolt zinc plated M6 Spring Washer zinc plated M6 T Nut nickel plated
---	---	---	---	---	---

Description	Fastening Set	Mass (g)	Part No.
Magnet Catch-14 (Profile 4040 for Door' Profile 4040 for Doorframe set No.4)	2xCG+2xPF+2xCK	147	7.41.14.4040.ST
Magnet Catch-14 (Profile 4040 for Door' Profile 4545 for Doorframe set No.5)	2xCG+2xPF+2xCN	151	7.41.14.4045.ST
Magnet Catch-14 (Profile 4040 for Door, Profile 4080 for Doorframe set No.6)	2xCL+2xCY	255	7.41.14.4080.ST
Magnet Catch-14 (Profile 4545 for Door' Profile 4545 for Doorframe set No.4)	2xCG+2xPF+2xCN	151	7.41.14.4545.ST



Door and Window Elements

Door lock

Material: DoorLock-black electrophoresis
Block-diecast aluminum, black electrophoresis

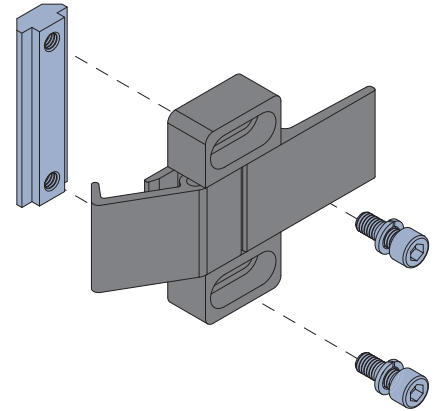
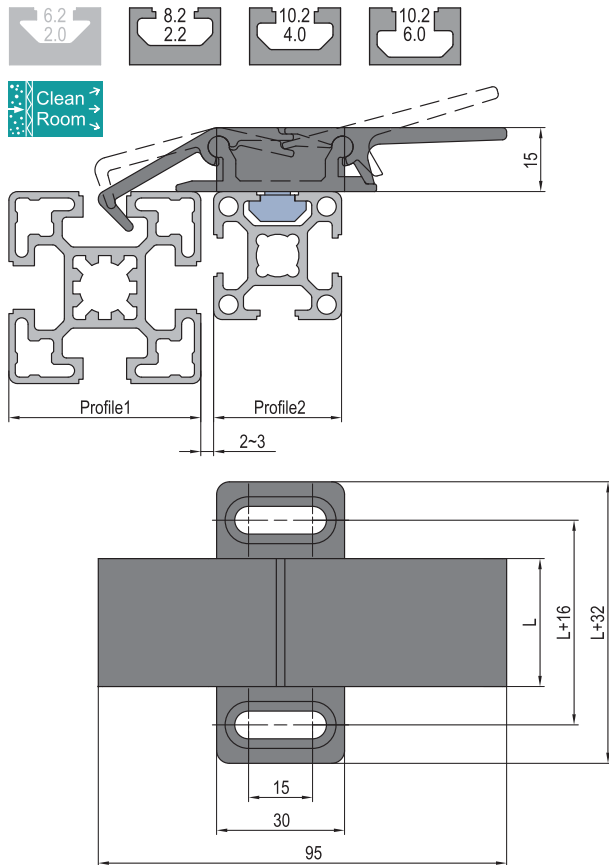

Description	Profile 1	Profile 2	L (mm)	Fastening Set	Mass (g)	Part No.
Door Locks-3040	PG40	PG30	30	2xCU+1xEP	115	7.42.30.3040
Door Locks-3045	PG45	PG30			115	7.42.30.3045
Door Locks-4040	PG40	PG40	50	2xCU+1xEP	140	7.42.30.4040
Door Locks-4045	PG45	PG40			185	7.42.30.4045
Door Locks-4545	PG45	PG45	50	2xCV+1xEP	187	7.42.30.4545

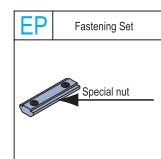
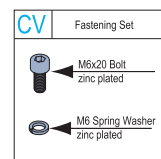
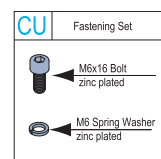

Note: including block and special nut.

2 The length could be customized according to customer's requirement(30~80mm)

ex: 7.42.30.3040 - 50



Door and Window Elements

Sliding Door Profile

The sliding door profile clips into strut profiles and is suitable for light-weight sliding doors.

Material and Colors: Sliding door profile-PVC, grey PE Bar-HD-PE, Nature.

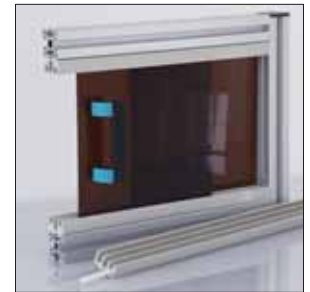

Sliding Door Profile-8

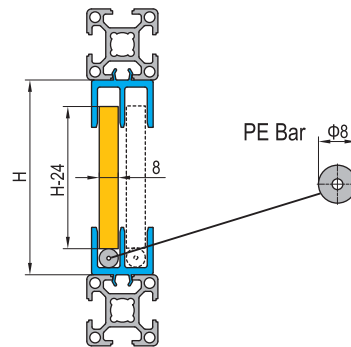
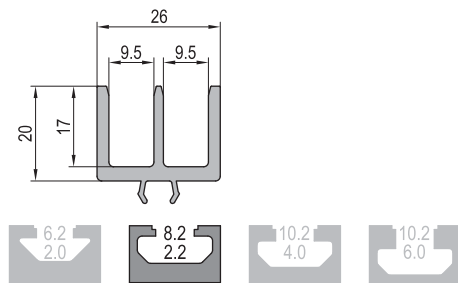

Sliding Door Profile-10-4

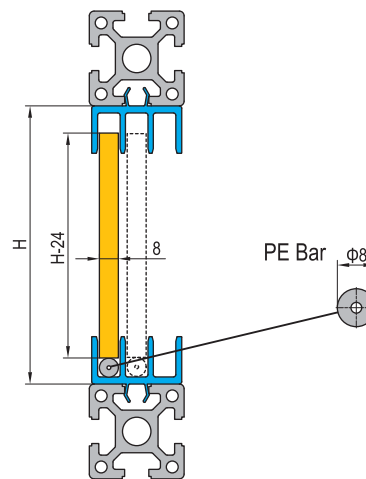
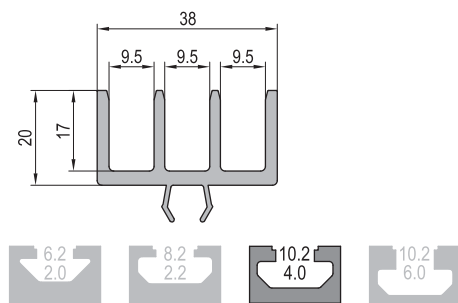

Description	PG	Mass (g/m)	Delivery Length	Part No.
Sliding Door Profile-8	PG30	330	3000mm/bar	7.51.08
Sliding Door Profile-8 (Including 2 pcs PE bar)		390		7.51.08.ST
Sliding Door Profile-10-4	PG40	450		7.51.10.04
Sliding Door Profile-10-4 (Including 2 pcs PE bar)		510		7.51.10.04.02.ST
Sliding Door Profile-10-4 (Including 3 pcs PE bar)		540		7.51.10.04.03.ST



Door and Window Elements
门窗组件

Magnet Catch
门碰

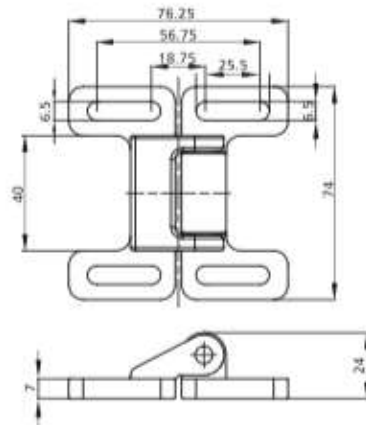

Description 产品描述	Material 材质	Mass 重量 (g/pcs)	Part No. 订购编号
Magnet Catch 门碰	Nylon 尼龙	49	8.42.01

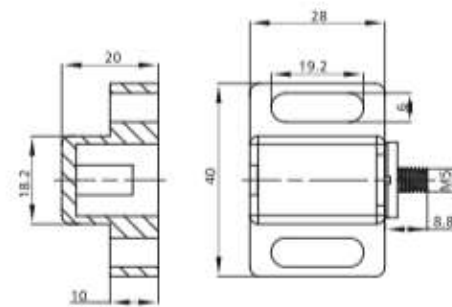

Description 产品描述	Material 材质	Mass 重量 (g/pcs)	Part No. 订购编号
Magnet Catch 门碰	Nylon+Steel 尼龙+钢	36.7	8.43.01

Additional Accessories
其他附件
Cable Clip
线夹

Cable Clips for mounting cables on the profiles.
 线夹用于将线缆安置于型材上。
 Material and Color: Black Nylon
 材质: 尼龙 黑色

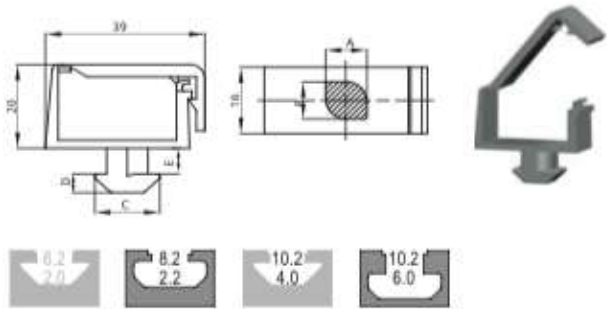
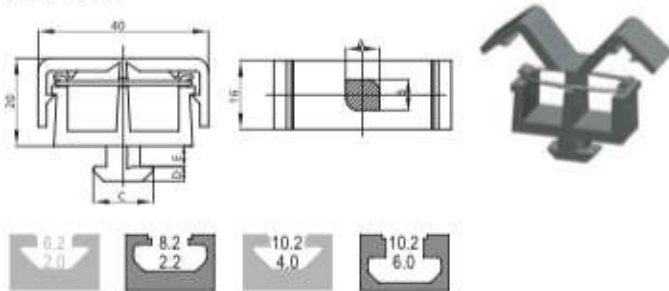
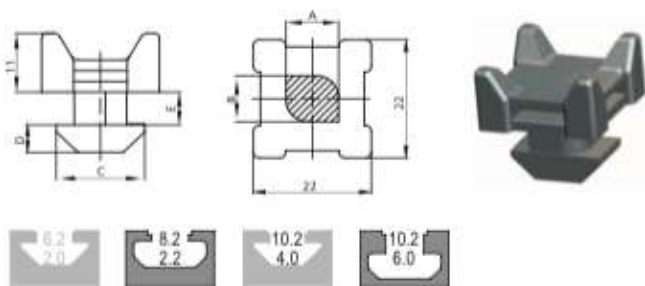
Cable Clips-Type A
线夹-型号A

Cable Clips-Type B
线夹-型号B

Cable Clips-Type C
线夹-型号C

Description 产品描述	A (mm)	B (mm)	C (mm)	D (mm)	E (mm)	Mass 重量 (g)	Part No. 订购编号
PG30-Type A 30系列-A型	8	7	14	3	4.5	7.5	8.71.08A
PG45-Type A 45系列-A型	9	8.5	16	4.5	6	8	8.71.10.06A
PG30-Type B 30系列-B型	8	7	14	3	4.5	9.25	8.71.08B
PG45-Type B 45系列-B型	9	8.5	16	4.5	6	9.25	8.71.10.06B
PG30-Type C 30系列-C型	8	6.8	16	5	4.5	9.5	8.71.08C
PG45-Type C 45系列-C型	9.8	8.5	17	5	6	10.25	8.71.10.06C

